

TECH LINK™

 RECHARGE

Warranty & Information Manual

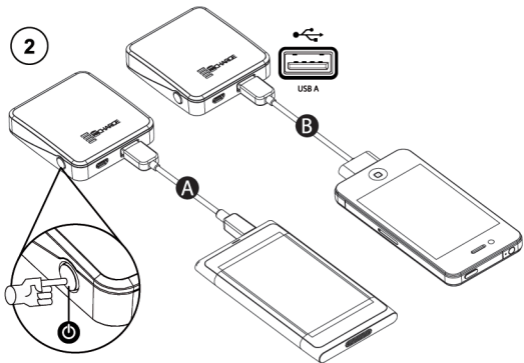

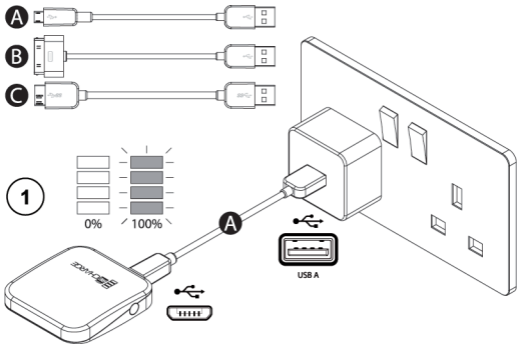

## Compatibility

The Recharge products are primarily designed for use with the latest smartphone and tablet devices; however they can also be used to power small USB devices such as Bluetooth headsets and portable music players.

If you are experiencing problems with your charging performance please refer to the FAQ section of this manual or our website.

This manual will cover the usage over the following Recharge devices Recharge 2500, Recharge 6000 and Recharge 10000.

## Warning

Take care to read and understand all instructions and warning notices laid out in this guide so that you can receive the full Recharge experience when using the device.

- Always unplug the Recharge device when not in use.
- Only recharge the Recharge device using the Micro USB Cable supplied.
- Keep the Recharge device away from water or moisture.
- Do not modify, disassemble, open, crush, puncture or shred the Recharge device.
- Do not operate the Recharge device in enclosed, unventilated spaces as it may cause overheating and damage the Recharge device.
- Avoid dropping the Recharge device, if excessive wear appears due to dropping, scraping or crushing, contact Techlink or dispose of the device at your nearest battery recycling point.
- If you find the device is excessively hot, emitting an odour, deforming, discolouring or displaying unexpected or abnormal behaviour please contact Techlink immediately.
- The Recharge device will operate at full capacity for a limited number of cycles and will eventually stop charging fully. Once this has occurred please dispose of the battery safely and in accordance with local laws and regulations.
- Do not charge a smartphone, tablet or USB device through the Recharge unit whilst it is recharging from a mains power supply.

## Cleaning and Maintenance

Avoid using harsh chemicals or excessive levels of moisture when cleaning the product. If in doubt use a dry or very lightly dampened cloth to wipe away dirt from the Recharge device. Avoid getting fluid into the USB ports or joins around the casings.

Do not attempt to repair or replace components from the Recharge device. If there is damage either dispose of the unit safely and in accordance with your local laws and regulations or contact Techlink.

## Charging tips

### How to charge the Recharge device.

Connect the USB Cable (A for Recharge 2500 and 10000) (C for Recharge 6000 Hub) to the Recharge device's Power IN port.

The LED lights will flash until that portion is charged (25% charge of battery per LED) and the indicator will then turn solid until all LED lamps are solid.

Charge the Recharge device only as described using the provided cable as described, do not alter the way the device can be charged.

### How to charge your smartphone with the Recharge device.

Connect your smartphone with the compatible USB cable (This device is also compatible with Lightning Connectors and other USB charging cables, sold separately) to the Recharge device; then press the button on the side of the unit to switch on; the indicator lights will flash until that portion of the battery is depleted. Once fully charged disconnect your smartphone and the Recharge device will switch off after 30 seconds.

Only use authorised cables or the cables supplied with your smartphone, tablet or USB peripheral to charge from a Recharge device.

Re-charge your Recharge device once every 3 months when not in use to maintain the lifespan of the battery.

To see what charge is remaining in your Recharge device press the indicator button and the LED's will light up. Four LED's lit up means the Recharge battery is full and One LED indicates that the Recharge battery requires charging.

It is normal that the Recharge device will get warm during the charging process.

The device does not have to be fully discharged before starting a new charging cycle.

To maintain full storage of your Recharge device, please charge the product for one hour after all the lights have turned to their solid state on its first charge.

## FAQ's

Q. When I connect a smartphone or tablet to the Recharge device nothing happens.

A. Press the button on the side to switch the Recharge unit on. If nothing still happens the Recharge unit may need recharging.

Q. What devices can be charged on my Recharge device?

A. Please see the compatibility diagram.

Q. Can I connect a Lightning Connector device to a Recharge product?

A. Yes, the Rechargev units are fully compatible with Lightning Connectors but you will need to provide this cable separately.

Q. Why don't the LED lamps switch on when charging?

A. Check the Micro USB cable is connected properly and the power is switched on at the source of the charge. i.e. wall socket or computer.

Q. How do I charge the Recharge Device?

A. The Recharge device's battery is powered by USB; therefore you can plug it into any computer, games console, wall socket adapter with a USB socket.

Q. Can I charge my device whilst charging the Recharge unit?

A. For the 2500 and 10000 models we do not recommend charging both devices at the same time as it could damage the Recharge unit and/or your device. However for the 6000 hub you are able to charge and sync devices and the Recharge unit when connected to a computer/notebook.

### **Warranty information**

All Recharge devices are covered by a One (1) year warranty against the defects or fault from the date of the original purchase. Please retain your receipt as proof of purchase. This does not affect your statutory rights.

#### **The warranty does not cover**

- 1) misuse or abuse of this product.
- 2) operation outside of directed use.
- 3) unauthorized service or modification.

Please contact Techlink to obtain service, repair or refund under warranty.

### **Legal**

The Recharge devices are certified to FCC, CE, RoHS, WEEE and MFi standards and regulations. Please contact Techlink for further information.

Every effort has been made to provide accurate and complete information in this manual, no liability will be made for errors and/or omissions made. Techlink reserves the right to make changes and improvement to all capacities of the Recharge device including: specifications, features, hardware and firmware of the product described in this manual without prior notice.

**©2013 by Techlink. All rights reserved. Techlink and other Techlink marks are owned by Techlink and may be registered. All other marks are the property of their respective owners.**

[www.techlink.uk.com](http://www.techlink.uk.com)



**0800 634 2699**



**spares@techlink.uk.com**

**TECHLINK , A Division Of Tapehand Ltd.**

Units 7 and 8 Bat and Ball Enterprise Centre

Bat and Ball Road

Sevenoaks

Kent

United Kingdom

TN14 5LJ